

# FOR SERVICE REFERENCE ONLY

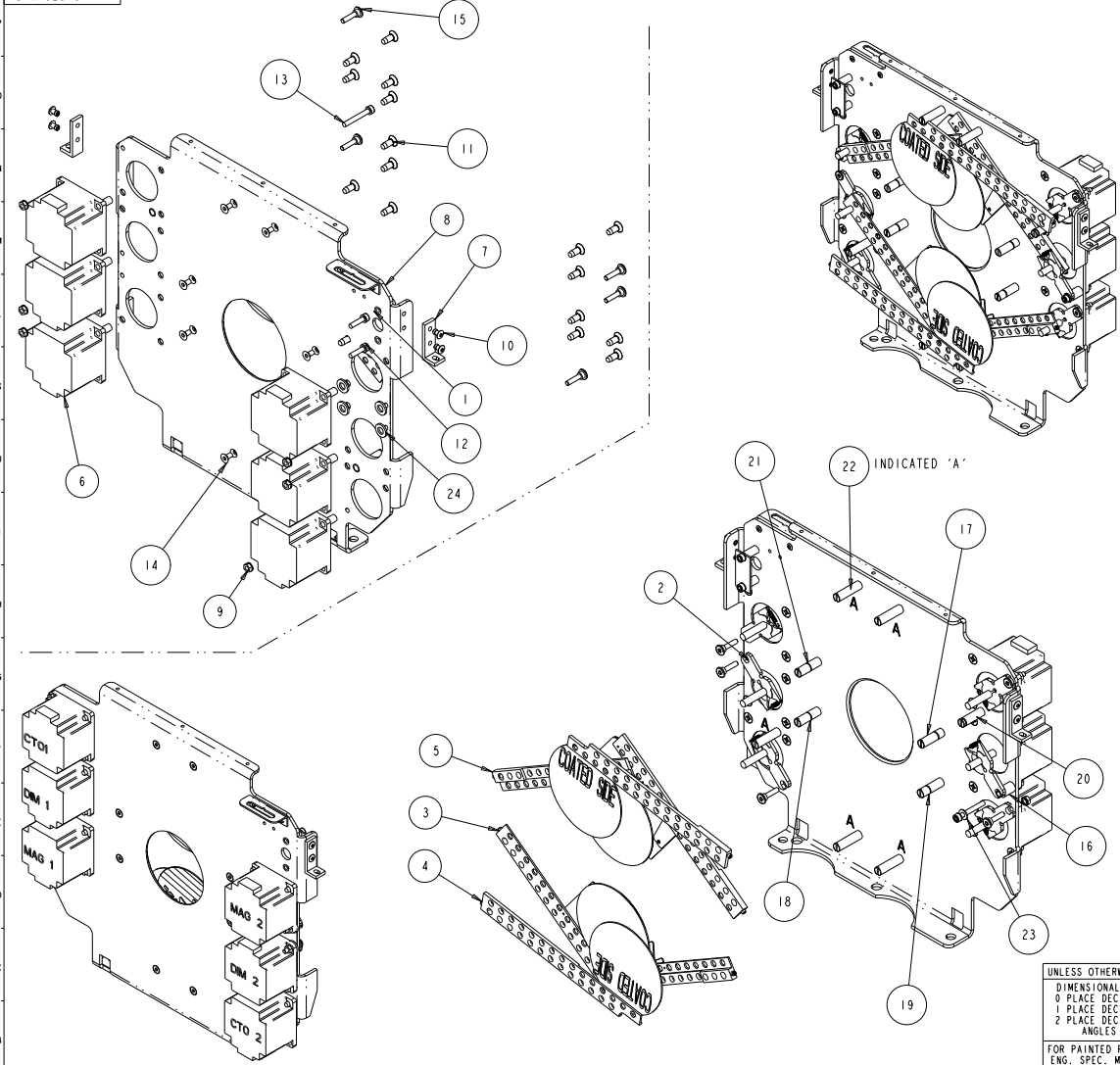

ITEM NO.	QTY.	FILENAME	PART NO.	DESCRIPTION
24	4	WASHER_265_500_SS	90706020	WASHER, 1/4 FLAT SS .265x .50x .064
23	1	WASHER8-32S	90706009	WASHER, #8 FLAT SS .174 X .375 X .032
22	5	TQ368	85000273	STOP, M4, GROOVELESS, I, 1 LG
21	1	TQ392	85000274	STOP, M4, DIM/STROBE/CTO, MAG 2
20	1	TW393	85000268	STOP, MAGENTA 2
19	1	TW392	85000267	STOP, MAGENTA 1
18	1	TW391	85000266	STOP, DIM/STROBE #2
17	1	TW390	85000265	STOP, DIM/STROBE #1
16	1	TW377	90702375	STANDOFF, BRAKE MOUNT
15	5	TW378	90702373	SCREW, SHOULDER, M4, MOTOR MOUNT
14	8	SCREWM4AF08BZ	91040408	SCREW, M4 SOCKET CSNK FLAT 08 BZ W/PATCH
13	1	SCREWM4AC30W-BZ	91000430	SCREW, M4 SOCKET CAP 30 BZ SEMS
12	2	SCREWM4AC16W-BZ	91000416	SCREW, M4 SOCKET CAP 16 BZ SEMS
11	17	SCREW12-24PF500TL-SZ	90711060	SCREW, 12-24 PHIL FLAT 1/2 THRD ROLL, TRI LOBE
10	4	RIVET54A0B_	90701197	RIVET, 5/32 DOME .188 - .250 ALUMINUM
9	6	NUTM4KEP	91201204	NUT, M4 KEPS
8	1	TO132	99260570	MOUNT, DIM/STROBE/CTO SHB
7	2	TQ343	99260571	MOUNT, ANGLE, BULKHEAD, D/S SHB
6	6	MRO09	99270083	MOTOR, STEPPER NMB 23KM-K286-01V
5	2	TWA072	80560043	FLAG, ASSY, MAGENTA SG
4	2	TOA029	80560050	FLAG, ASM, C-T-O, SHB
3	2	TWA096	80560040	FLAG ASSEMBLY, DIM/STROBE
2	6	TWA083	80140039	DAMPER ASSY, MTR BRAKE, HI-TEMP, .25 DIA
1	1	FS719	80040024EF	BOARD ASSY TEMP SENSOR

UNLESS OTHERWISE SPECIFIED: DIMENSIONAL TOLERANCES: 0 PLACE DECIMAL = ±0.38, 1 PLACE DECIMAL = ±0.25, 2 PLACE DECIMALS = ±0.13, ANGLES = ±0.5°

RELEASE DATE: \_\_\_\_\_ CE: \_\_\_\_\_  
 ENG: \_\_\_\_\_ OA: \_\_\_\_\_  
 ME: \_\_\_\_\_ DRW: \_\_\_\_\_  
 MEG: \_\_\_\_\_

DESCRIPTION: BULKHEAD, ASM, DIM/STROBE SB

MATERIAL: CHARTED FINISH: NA

FOR PAINTED PARTS REFER TO ENG. SPEC. MANUAL WI-0582

MIN. DRAFT \_\_\_\_\_ INTERPRET DIMENSIONS PER ASME Y14.5M-1994

MIN. RADI1 \_\_\_\_\_ THIRD ANGLE PROJECTION

FLATNESS \_\_\_\_\_ THICKNESS \_\_\_\_\_ DIMENSIONS ARE IN MILLIMETERS

VOLUME \_\_\_\_\_

SI METRIC A1 PART NO. INTERNAL TQA048\_SVC DRAWING NO. REV.

DO NOT SCALE SCALE: 0.333 SHEET: 1 OF 2

**High End** 2105 GRACY FARMS LANE  
 AUSTIN, TEXAS 78758  
 (512) 836-2242  
 FAX (512) 832-4128  
 \*\*\*\*\* http://www.highend.com

**Lightwave Research**

**PROPRIETARY NOTICE:**  
 THIS DOCUMENT CONTAINS CONFIDENTIAL AND PROPRIETARY INFORMATION OF HIGH END SYSTEMS INC., (ALSO DBA LIGHTWAVE RESEARCH) AND IS GIVEN TO THE RECEIVER IN CONFIDENCE. THE RECEIVER ACCEPTS AND AGREES THAT, EXCEPT AS AUTHORIZED BY HIGH END SYSTEMS, THE RECEIVER WILL NOT PERMIT THE USE OF THE INFORMATION OR ANY COPY THEREOF OR THE INFORMATION THEREIN, WILL NOT COPY OR PERMIT COPYING THE DOCUMENT OR THE INFORMATION THEREIN, AND WILL UPON COMPLETION OF THE NEED TO RETURN THE DOCUMENT, OR UPON DEMAND, RETURN THE DOCUMENT WITHOUT RETAINING ANY OF THE INFORMATION CONTAINED THEREIN IN ANY FORM WHATSOEVER.

FOR SERVICE  
REFERENCE ONLY

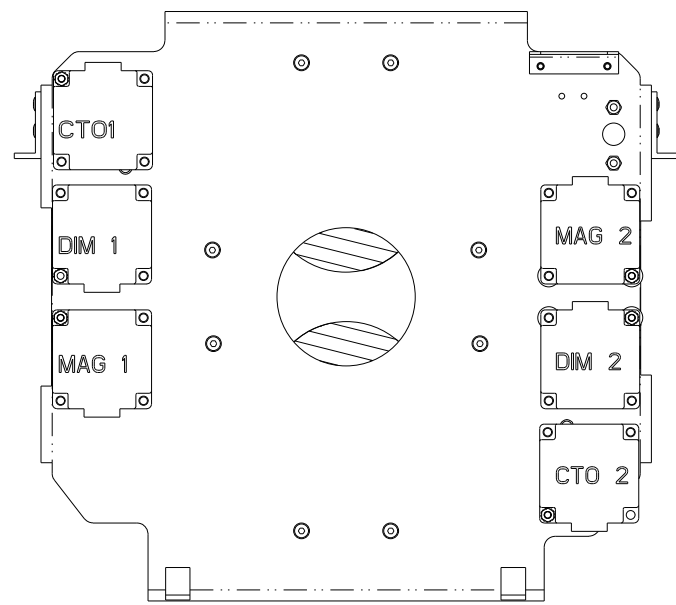
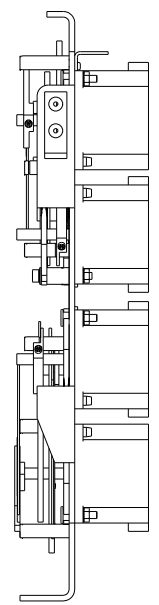
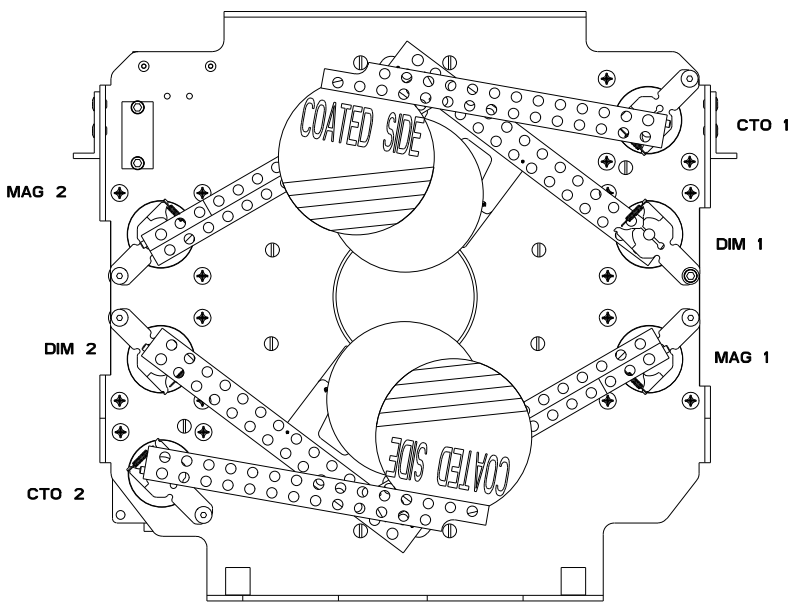

**PROPRIETARY NOTICE:**  
THIS DOCUMENT CONTAINS CONFIDENTIAL AND PROPRIETARY INFORMATION OF HIGH END SYSTEMS INC., (ALSO DBA LIGHTWAVE RESEARCH) AND IS GIVEN TO THE RECEIVER IN CONFIDENCE. THE RECEIVER ACCEPTS AND AGREES THAT, EXCEPT AS AUTHORIZED BY HIGH END SYSTEMS, THE RECEIVER WILL NOT PERMIT THE USE OF THE DOCUMENT OR ANY COPY THEREOF OR THE INFORMATION THEREIN, WILL NOT COPY OR PERMIT COPYING THE DOCUMENT WILL NOT DISCLOSE TO OTHERS EITHER THE DOCUMENT OR THE INFORMATION THEREIN, AND WILL UPON COMPLETION OF THE NEED TO RETAIN THE DOCUMENT, OR UPON DEMAND, RETURN THE DOCUMENT WITHOUT RETAINING ANY OF THE INFORMATION CONTAINED THEREIN IN ANY FORM WHATSOEVER.

UNLESS OTHERWISE SPECIFIED DIMENSIONAL TOLERANCES: 0 PLACE DECIMAL = ±0.38 1 PLACE DECIMAL = ±0.25 2 PLACE DECIMALS = ±0.13 ANGLES = ±0.5°	RELEASE DATE:	CE:	High End 2105 GRACY FARMS LANE AUSTIN, TEXAS 78758 (512) 836-2242 FAX (512) 832-4128 http://www.highend.com	
	ENG:	OA:		
FOR PAINTED PARTS REFER TO ENG. SPEC. MANUAL WI-0582 ALL COMPONENTS, MATERIALS AND FINISHES TO BE R6HS COMPLIANT	MEG:	DRW:	DESCRIPTION: BULKHEAD, ASM, DIM/STROBE SB	
MIN. DRAFT	MATERIAL:		FINISH:	
MIN. RADI	CHARTED		NA	
FLATNESS	INTERPRET DIMENSIONS PER ASME Y14.5M-1994		PART NO. INTERNAL TQA048_SVC	
THICKNESS	THIRD ANGLE PROJECTION		DRAWING NO. TQA048_SVC	
VOLUME	DIMENSIONS ARE IN MILLIMETERS		REV.	
	SI METRIC A1		DO NOT SCALE SCALE: 0.750 SHEET: 2 OF 2	